

Two identical halves clip together over a new or existing electrical wire connection to form a compliant junction box, without having to disconnect and reconnect the wires.

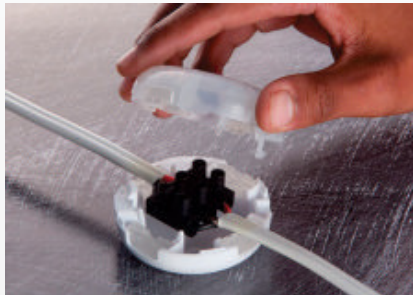

Application

Designed & manufactured in South Africa to create an industry compliant electrical junction box. Comes as a complete unit (excluding the connector block) Ingress of solid objects: IP rating 2X. Ingress of water: IP rating X0. Once closed, a twist of a screwdriver is required to reopen the unit for added safety.

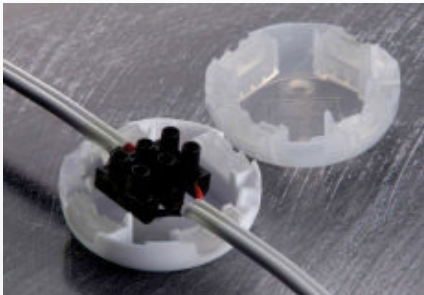

Packaging

10 units per clear plastic bag. Packed in cardboard boxes of 25 bags per box (250 units per box)
Weight per box: 9.180 Kg. Dimensions: 310x460x300 mm

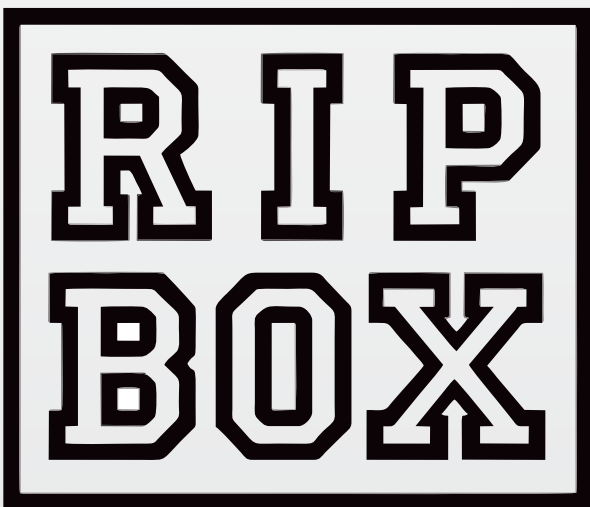

TM



Specification

Outer Material: Natural Polypropylene Random Co-polymer. Robust construction and non-toxic.
Inlet Cable-Grab Pads: TPE (Thermo Plastic Elastomer) at a 55 shore hardness.
Designed to shape around cable for snug fit. Cable: 1,5mm - 2, 5mm FT & E and Surfix 2,5mm.
Colour: Transparent top for quick inspection with opaque white bottom.

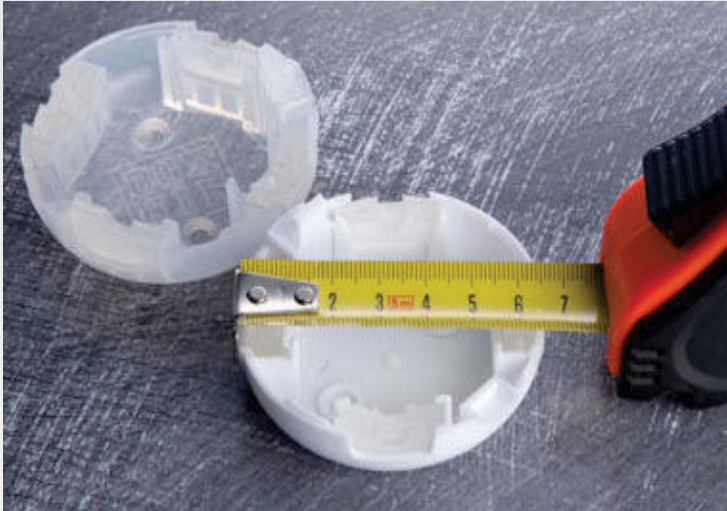

Why RIPBOX

Every new/existing structure built or sold must have amongst other things, an electrical compliancy certificate. Importantly, all electrical connections must be enclosed. Research has shown that in most structures inspected, any number of non compliant wiring connections can be found. The current method of enclosing electrical connections has been around for over 100 years and not much has changed other than the material used. RIPBOX is the fast new way of enclosing electrical connections in a fraction of the time it would normally take using the current products available.

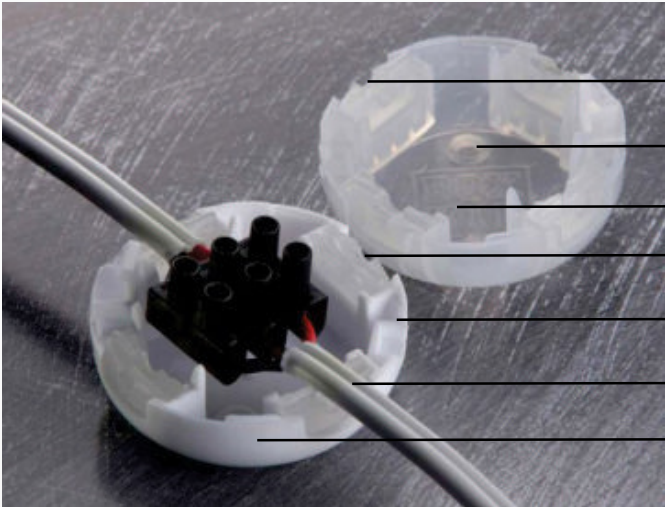
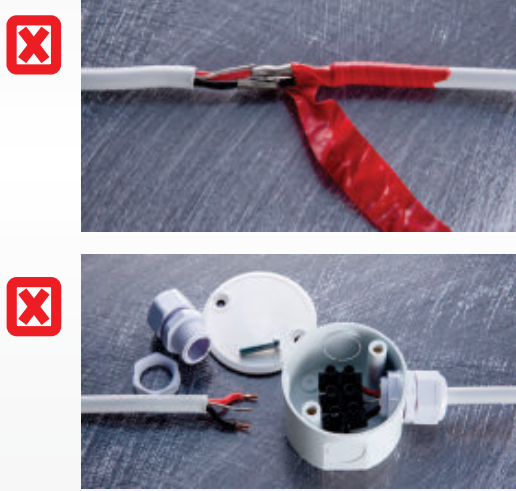

- Rubber inserts mould themselves around most wire shapes
- Screw guides for convenience
- Two identical halves for quick click installation
- Has 4 ports for multiple connections
- A twist of a screwdriver opens the box
- No need to disconnect wires to install
- Dust proof & moisture resistant

YOUR CONNECTION 100% COMPLIANT... IN A CLICK!